

Use this guide to configure your new FieldPro printer prior to use. Printers may also be ordered from PrintekMobile pre-configured, if desired.

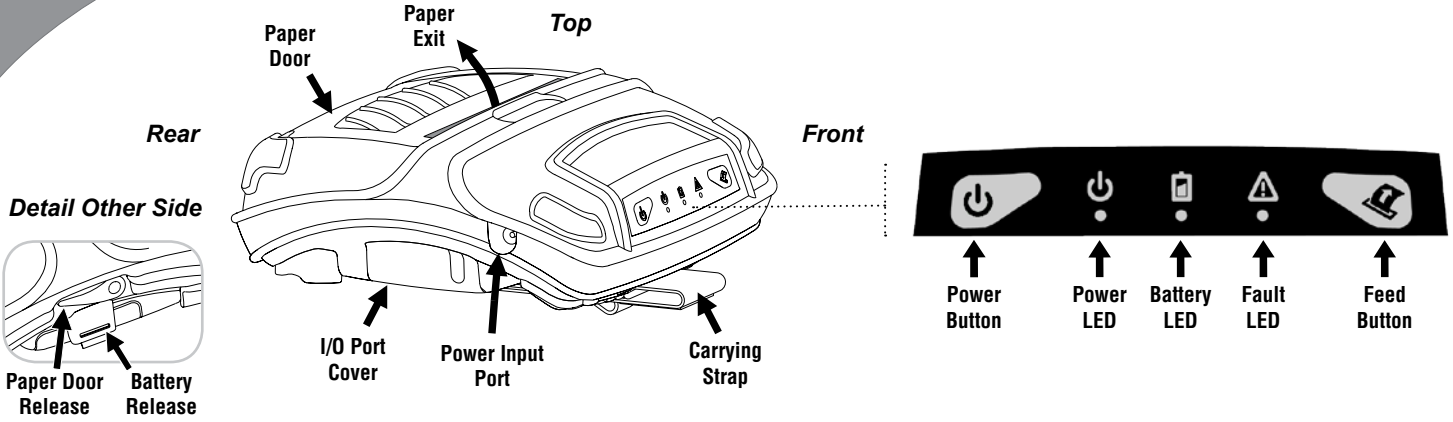

1 Charge the Battery

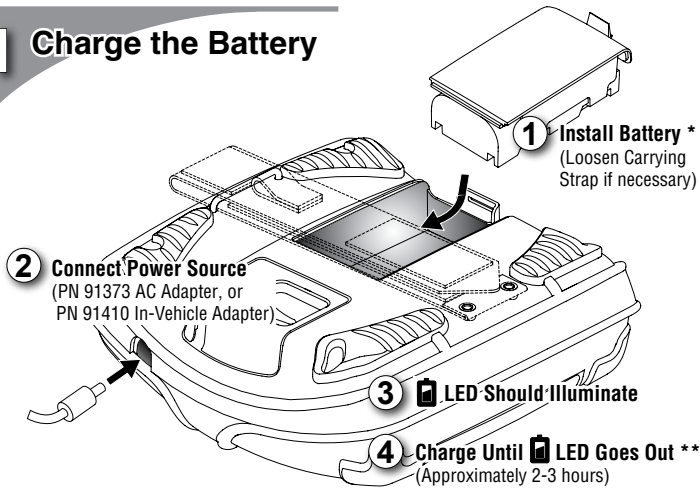

2 Load Paper

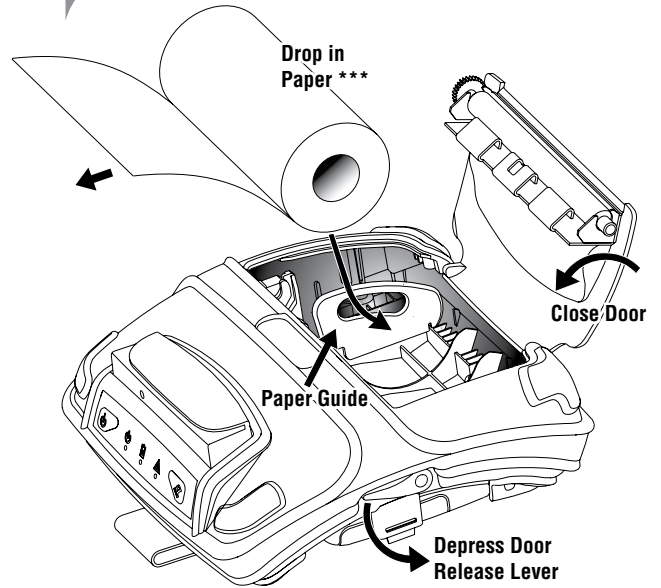

3 Perform Printer Test

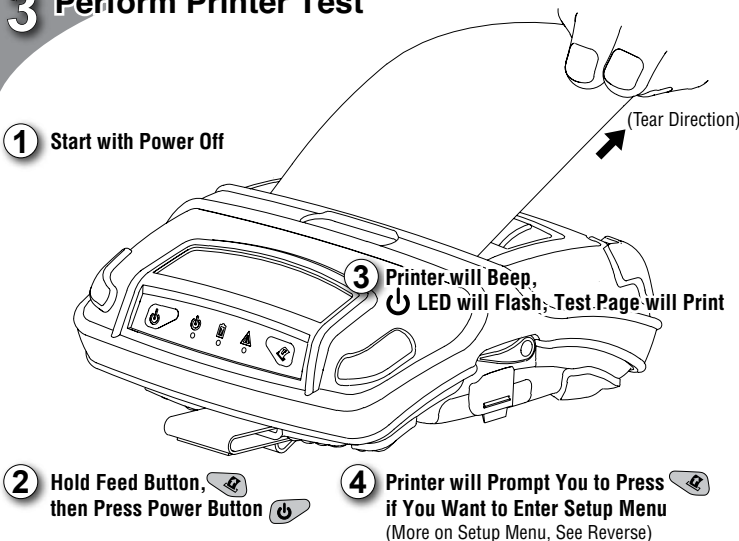

* FieldPro printers may be operated directly from an external power source without a battery present. If no battery is to be used, battery charging may be skipped. (A battery compartment cover is available from PrintekMobile).

** Maximum battery capacity is reached only after completing three complete charge and discharge cycles. PrintekMobile recommends completing three cycles before deploying your printer for best results.

*** With media rolls of less than 4" width we recommend addition of a second paper guide. See reverse for details.

More detailed instructions can be found in the Operator's Manual, available at www.printekmobile.com

FieldPro Model RT43 Quick Setup Guide

4 Install Second Paper Guide (not necessary for standard 4" roll)

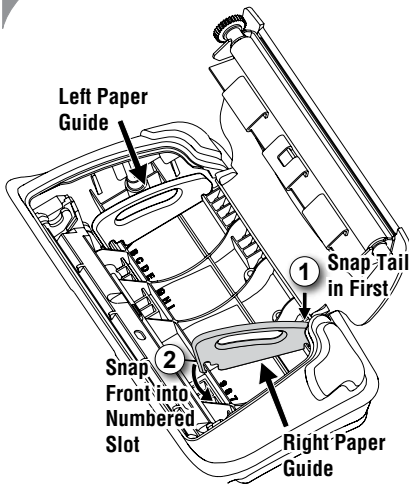

To use the FieldPro for printing on PrintekMobile standard 3" paper (3.125" wide), insert the second paper guide in slot 7. This will left align the roll.

In Options menu, set the "Rt. Paper Guide" setting to 7. This will insure test pages print and margins are measured correctly.

For paper rolls less than 4" wide that are not standard PrintekMobile rolls, consult operators manual for more instructions on proper installation and configuration.

5 Configure Carrying Strap (if necessary)

The carrying strap may be converted to a belt loop or connected to our Shoulder Strap Accessory (PN 91868, sold separately)

Belt Loop Conversion

Detach the carrying strap, thread behind and over belt, and re-attach using the two outside velcro pads provided.

Shoulder Strap Attachment

Detach the carrying strap, thread through the opening on the triangular end of the shoulder strap, and re-attach the inside velcro pads.

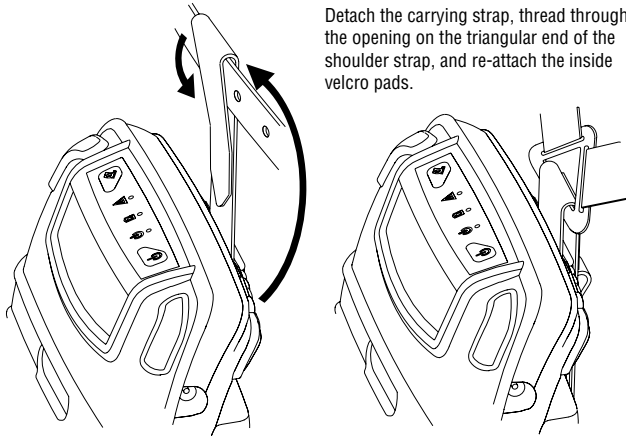

Optional MCR Module

Correct Card Orientation

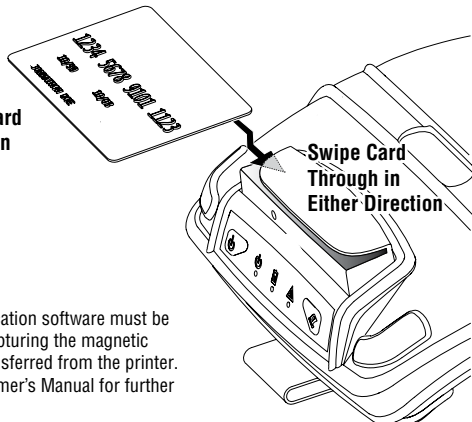

NOTE: Application software must be capable of capturing the magnetic card data transferred from the printer. See Programmer's Manual for further information.

FieldPro On-Board Menu

Menu Navigation		
Enter Setup Menu		Follow instructions for printing test page. The end of the test page printout includes a prompt to press the feed button to enter setup.
Select/Change		Menu choices will print out. To select (enter) a menu or change the most recently printed item, press the power button.
Go To Next		At any level in the menu structure, press the feed button to go to the next item.
Exit Menu	Hold 1 sec	Shortcut - Exit from a menu and go to the next menu <i>OR</i> Exit and Save Changes (if changes have been made).
Power Off (from setup menu)	Hold 2 sec	Shortcut - To turn the printer off in setup mode and discard any menu changes, press and hold the power button for 2 seconds.
Menu Structure		
Menu List	Menu Items	
Interface Menu	Emulation, Print Interface Settings <i>For Serial Interface:</i> Baud Rate, Parity, Data Bits, Stop Bits, RTS/CTS, XON/XOFF <i>For Bluetooth Interface:</i> Pairing Mode, Security, Role Policy, Discoverability <i>For Wi-Fi Interface:</i> Wi-Fi Default Peer-to-Peer (for more info see operators manual)	
Format Menu	Font, Left Margin, Right Margin, Print Contrast, Max Paper Speed, FFeed Distance <i>When Using Mark Sensing:</i> Mark Sensitivity, Top Of Form Adj, Tearbar Adjust	
Print All Logos in Memory	Select to print graphic files loaded in flash memory	
Options Menu	Left Paper Guide, Rt. Paper Guide, Auto Power Down, Print Promo, Print Header	
Hardware Menu	Enter HEX DUMP Mode, Reset to Factory Defaults	
Exit Menu Discard Changes	Select to exit the menu without saving	
Exit Menu Save Changes	Select to exit the menu while saving	
Tips	The menus are cyclical and will return to the top of the list after the last item in each menu level. The on-board menu is for convenience. Use the PrintekMobile Setup Utility when possible. For more information on menus see the operator's manual.	

Control Indicators

Symbol	LED State	Indicates	Cause
		Power Off	Printer turned off <i>OR</i> No power available
		Power On	Printer turned on, Normal operating state
		Printer Standby	Printer in standby mode (will wake with data)
		Printer Busy	Printer receiving data <i>OR</i> Printer is in setup mode
		Charging	Battery is receiving charge from external power
		Battery Low	Battery charge is low, printer is in standby mode
		Battery Low	Battery charge is low, printer is in normal operating state
		Paper Door Open	Paper door is open, preventing paper feed
		Paper Out Fault	Paper roll empty or paper not fed properly
		Communication Fault	Problem receiving data. Turn off printer to reset
LED State Key:	LED Off LED On (Illuminated)	LED Slow Blink LED Rapid Flash	Audible Tone